

1

2

3

4

Note:

- 1. Material: Copper Alloys, Tin Plated.
- 2. Contact Resistance: 10mΩ max.
- 3. Applicable Wire: AWG#26 to 22  
Insulation OD: 1.4 to 1.7mm
- 4. Housing : GT83015-F4464.
- 5. RoHS Compliant.

REV	ECN#	DESCRIPTION OF REVISION	DRAW BY DATE	CHECK BY DATE	APPROVE BY DATE
A0		Mass Production	Lucas 01/22/20	Lucas 01/22/20	Ray 01/22/20

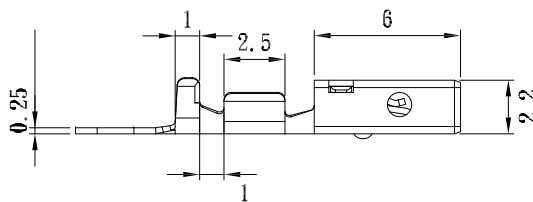
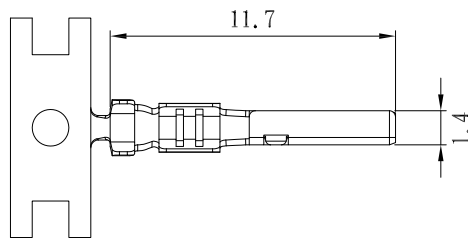

GT Contact CO.,LTD

NOTICE OF PROPRIETARY PROPERTY:

THE INFORMATION CONTAINED HEREIN IS THE PROPRIETARY PROPERTY OF GT Contact CO.,LTD THE POSSESSOR AGREES TO THE FOLLOWING:

- (i) TO MAINTAIN THIS DOCUMENT IN CONFIDENCE
- (ii) NOT TO REPRODUCE OR COPY IT
- (iii) NOT TO REVEAL OR PUBLISH IT IN WHOLE OR PART
- (iv) ALL RIGHTS RESERVED

TITLE Female Terminal					DRAWING NUMBER GT83013-F1564		REV. A0
	N/A	Lucas 01/22/20	Lucas 01/22/20	Ray 01/22/20	ALL ANGLES ± 0.3 ± 1°	mm	1/1
THIRD ANGLE PROJECTION	SCALE	DRAFTER / DATE	CHECK / DATE	APPROVE / DATE	TOLERANCES	UNIT	SHEET

1

2

3

4