

Notes: (Unless Otherwise Specified)

1. Waterproof Rate: IP68
2. Suitable Cable $\text{OD} = 5.0\text{mm}$ to 8.0mm
3. Recommend Cover Torque: $6\sim 7 \text{ Kgf-cm}$.
4. Recommend Gland Nut Torque: $10\sim 11 \text{ Kgf-cm}$.
5. RoHS Compliant.

| REV | ECN# | DESCRIPTION OF REVISION | DRAW BY DATE | CHECK BY DATE | APPROVE BY DATE |
|-----|------------|-------------------------|---------------------|-------------------|-----------------|
| A1 | ECN-200215 | Modify Housing | Whitney 02/25/20 | Lucas 02/25/20 | Ray 02/25/20 |

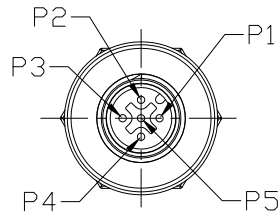

Pin Assignment

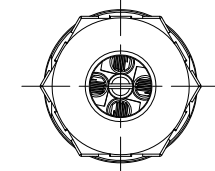
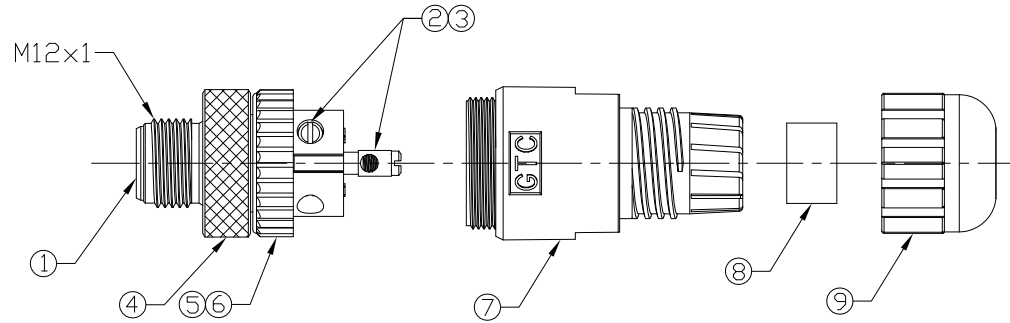

| 9 | Gland Nut | Thermoplastic Color: Black | 1 |
|------|---------------|-----------------------------------|------|
| 8 | Gland | NBR Color: Black | 1 |
| 7 | Cover | Thermoplastic Color: Black | 1 |
| 6 | D-Ring | Silicone Color: Black | 1 |
| 5 | Screw Nut | Thermoplastic Color: Black | 1 |
| 4 | Screw Nut | Copper Alloy Finish: Ni Plated | 1 |
| 3 | Machine Screw | Cutting Iron Finish: Ni Plated | 5 |
| 2 | Contacts | Copper Alloy Finish: Ni Plated | 5 |
| 1 | Housing | Thermoplastic Color: Black | 1 |
| Item | Part Name | Material / Finish | Q'TY |

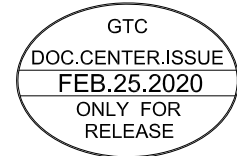
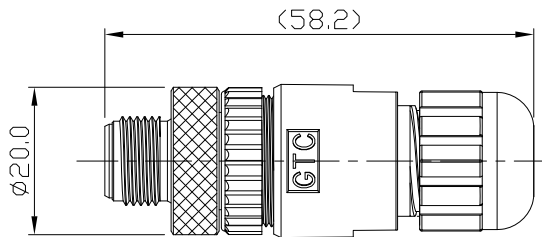

GT Contact CO.,LTD

NOTICE OF PROPRIETARY PROPERTY:

THE INFORMATION CONTAINED HEREIN IS THE PROPRIETARY PROPERTY OF GT Contact CO.,LTD THE POSSESSOR AGREES TO THE FOLLOWING:
 (a) TO MAINTAIN THIS DOCUMENT IN CONFIDENCE
 (b) NOT TO REPRODUCE OR COPY IT
 (c) NOT TO REVEAL OR PUBLISH IT IN WHOLE OR PART
 (d) ALL RIGHTS RESERVED

| TITLE | | | | | | DRAWING NUMBER | | | REV. | | |
|---|------|-------|----------------|----------------|----------------|----------------|------------------------|-----------------|-----------------------------|-------|-----|
| Micro 4A 5P Field Installable Cable End Male Screw-In | | | | | | GT271154-31050 | | | A1 | | |
| | B | 1:1 | Edwin 01/09/12 | Lucas 01/09/12 | Ray 01/09/12 | X.X X.XX | ± 0.5 ± 0.2 | X.XXX ANGLES | ± 0.05 $\pm 1^\circ$ | mm | 1/1 |
| THIRD ANGLE PROJECTION | SIZE | SCALE | DRAW / DATE | CHECK / DATE | APPROVE / DATE | TOLERANCES | | | UNIT | SHEET | |