

Notes: (Unless Otherwise Specified)

1. Waterproof Rate: IP68.
2. Cable Diameter: 4.0 to 6.5 mm.  $\triangle 2$
3. Recommend Cover Torque: 6~7 Kgf-cm.
4. Recommend Gland Nut Torque: 9~10 Kgf-cm.
5. RoHS Compliant.

REV	ECN#	DESCRIPTION OF REVISION	DRAW BY DATE	CHECK BY DATE	APPROVE BY DATE
A2	ECN-190103	Modify Notes: 2. Cable Diameter: 4.0 to 7.0 mm. → 4.0 to 6.5 mm.	Joyce 01/07/19	Lucas 01/07/19	Ray 01/07/19

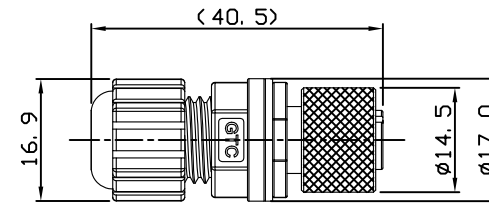
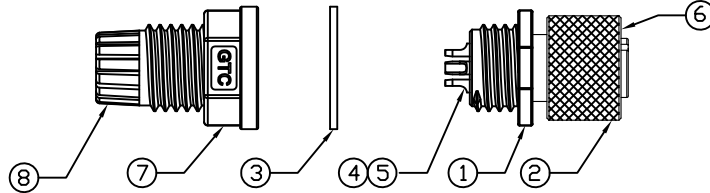
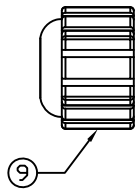

9	Gland Nut	Thermoplastic Color: Black	1
8	Gland	NBR Color: Black	1
7	Cover	Thermoplastic Color: Black	1
6	O-Ring	Silicone Color: Red	1
5	Glue	Epoxy Color: Black	
4	Contacts	Copper Alloy Finish: Au Plated	4
3	Gasket	EPDM Color: Black	1
2	Screw Nut	Copper Alloy Finish: Ni Plated	1
1	Housing	Thermoplastic Color: Black	1
Item	Part Name	Material / Finish	Q'TY

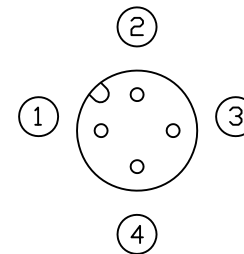

Pin Assignment

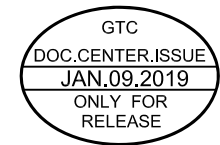

TITLE						DRAWING NUMBER			REV.
M12 A-Coding 4A 4P Field Installable Cable End Female Solder						GT234144-02040			A2
	B	1:1	Joyce 03/17/11	Lucas 03/17/11	Ray 03/17/11	X.X ± 0.5 X.XX ± 0.2	X.XXX ± 0.05 ANGLES ± 1°	mm	1/1
THIRD ANGLE PROJECTION	SIZE	SCALE	DRAW / DATE	CHECK / DATE	APPROVE / DATE	TOLERANCES		UNIT	SHEET

**GT Contact CO., LTD**

NOTICE OF PROPRIETARY PROPERTY:  
THE INFORMATION CONTAINED HEREIN IS THE PROPRIETARY PROPERTY OF GT CONTACT CO., LTD THE POSSESSOR AGREES TO THE FOLLOWING:  
(1) TO MAINTAIN THIS DOCUMENT IN CONFIDENCE  
(11) NOT TO REPRODUCE OR COPY IT  
(111) NOT TO REVEAL OR PUBLISH IT IN WHOLE OR PART  
(1V) ALL RIGHTS RESERVED