

4

3

2

1

REV	ECN#	DESCRIPTION OF REVISION	
A1	ECN-200821	Change Torque Of Screw Tightening: 9~10 kgf/cm → 14~15 kgf/cm.	082720

Notes: (Unless Otherwise Specified)



1. Waterproof Rate: IP68
 2. Recommend Panel Thickness: 0.8 to 5.0 mm
 3. Recommend Torque: 14~15 Kgf-cm
 4. Durability: 100 Cycles Min.
 5. DWV: 650 Vrms
 6. Rated Voltage: 30V AC/DC
 7. Insulation Resistance: 100 M OHM Min.
 8. RoHS Compliance



1	Brown
2	White
3	Orange
4	Yellow
5	Green
6	Blue
7	Violet
8	Black

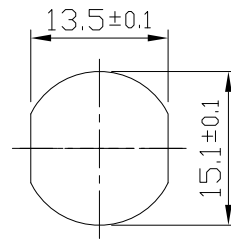

Recommend
Panel Cut Out

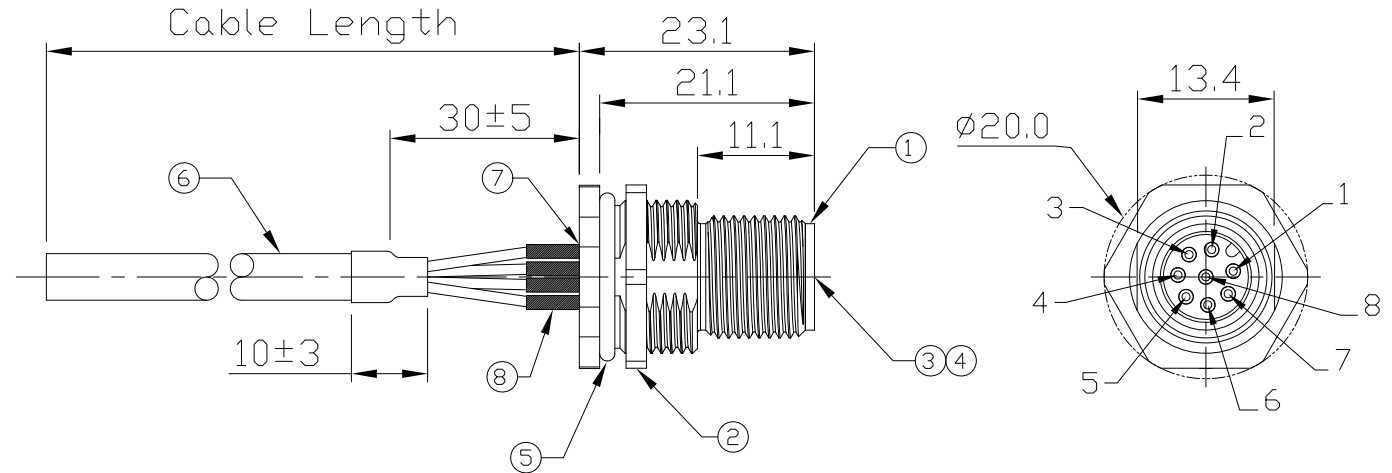

Wire Diagram

Part No.	Cable Length	Tol.
GT234112-01081-Z1	100 mm	±10
GT234112-01081-Z2	200 mm	±10
GT234112-01081-Z3	300 mm	±10
GT234112-01081-Z4	400 mm	±10
GT234112-01081-Z5	500 mm	±20
GT234112-01081-Z6	600 mm	±20
GT234112-01081-Z7	700 mm	±20
GT234112-01081-Z8	800 mm	±20
GT234112-01081-Z9	900 mm	±20
GT234112-01081-01	1000 mm	±50
GT234112-01081-02	2000 mm	±100

Item	Part Name	Material / Finish	Q'ty
1	Metal Body	Copper Alloy Finish: Ni Plated	1
2	Hex Nut	Copper Alloy Finish: Ni Plated	1
3	Housing	Thermal Plastic Color: Black	1
4	Contacts	Copper Alloy Finish: Au Plated	8
5	O-Ring	NBR Color: Black	1
6	Cable	UL2464 24#*8C+D+Al/My OD=5.3mm, Color: Black	1
7	Glue	Epoxy Color: Black	
8	Shrink Tube	L=10mm, 300V Color: Black	8

METRIC		GT Contact CO.,LTD	
DRAFTER	DATE	NOTICE OF PROPRIETARY PROPERTY: THE INFORMATION CONTAINED HEREIN IS THE PROPRIETARY PROPERTY OF GT CONTACT CO.,LTD. THE POSSESSOR AGREES TO THE FOLLOWING: (1) TO MAINTAIN THIS DOCUMENT IN CONFIDENCE (2) NOT TO REPRODUCE OR COPY IT (3) NOT TO REVEAL OR PUBLISH IT IN WHOLE OR PART (4) ALL RIGHTS RESERVED	
Vicky	12/13/10	TITLE M12 A-Coding 2A 8P Panel Male Solder With Cable	
DESIGN	DATE		
Ray	12/13/10	DRAWING NUMBER GT234112-01081-XX	
DIMENSIONS ARE IN MILLIMETERS TOLERANCES		REV. A1	
XX ±0.5 X.XX ±0.20		SCALE N/A	
ANGLES ±0.5°		SHT 1 OF 1	
DO NOT SCALE DRAWINGS			
THIRD ANGLE PROJECTION		SIZE B	

4

3

2

1