

1

2

3

4

Notes: (Unless Otherwise Specified)

- 1. Waterproof Rate: IP68.
- 2. Cable Diameter: 5.0 to 6.0 mm
- 3. Recommend Gland Nut Torque: 9.0 to 10.0 Kgf-cm.
- 4. Matting No.: GT225500 Series.
- 5. RoHS Compliant

| REV | ECN# | DESCRIPTION OF REVISION | DRAW BY DATE | CHECK BY DATE | APPROVE BY DATE |
|-----|------|-------------------------|---------------|----------------|-----------------|
| A0 | | Mass Production | Hank 09/07/15 | Lucas 09/07/15 | Ray 09/07/15 |

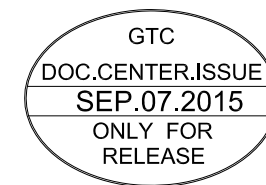
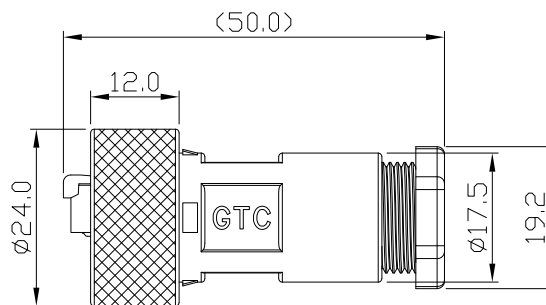
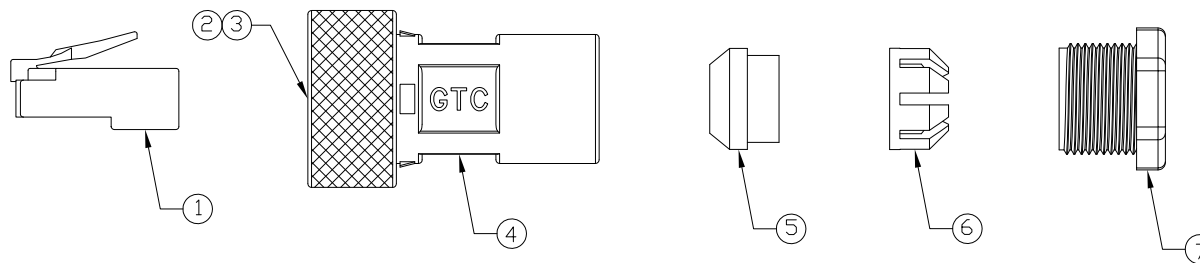

| | | | |
|------|------------|--|------|
| 7 | Gland Nut | Thermoplastic Color: Black | 1 |
| 6 | Cage | Thermoplastic Color: White | 1 |
| 5 | Gland | Silicone Color: Green | 1 |
| 4 | Housing | Thermoplastic Color: Black | 1 |
| 3 | Screw Nut | Copper Alloy Color: Green | 1 |
| 2 | Rubber Pad | Silicone Color: Black | 1 |
| 1 | RJ45 Plug | Housing: Thermoplastic, Color: Clean Contacts: Copper Alloy, Finish: Ni Plated Shell: Cold Roll Steel, Finish: Ni Plated | 1 |
| Item | Part Name | Material / Finish | Q'ty |

| TITLE | | | | | | DRAWING NUMBER | | | REV. | |
|--|------|-------|---------------|----------------|----------------|-------------------------|-----------------------------|------|-------|--|
| RJ45 Metal C3 Shielded E1 Field Installable Cable End Plug Screw | | | | | | GT225560-00(G) | | | A0 | |
| | B | 1:1 | Hank 09/07/15 | Lucas 09/07/15 | Ray 09/07/15 | X.X ± 0.5 X.XX ± 0.2 | X.XXX ± 0.05 ANGLES ± 1° | mm | 1/1 | |
| THIRD ANGLE PROJECTION | SIZE | SCALE | DRAW / DATE | CHECK / DATE | APPROVE / DATE | TOLERANCES | | UNIT | SHEET | |

GT Contact CO.,LTD

NOTICE OF PROPRIETARY PROPERTY:
 THE INFORMATION CONTAINED HEREIN IS THE PROPRIETARY PROPERTY OF GT Contact CO.,LTD THE POSSESSOR AGREES TO THE FOLLOWING:
 (a) TO MAINTAIN THIS DOCUMENT IN CONFIDENCE
 (b) NOT TO REPRODUCE OR COPY IT
 (c) NOT TO REVEAL OR PUBLISH IT IN WHOLE OR PART
 (d) ALL RIGHTS RESERVED

1

2

3

4