

- Notes: (Unless Otherwise Specified)
1. Waterproof Rate: IP67.
 2. Suitable Cable OD=21mm To 24mm
 3. Recommend Gland Nut Torque: 15~20 Kgf-cm.
 4. RoHS Compliant.

REV	ECN#	DESCRIPTION OF REVISION	DRAW BY DATE	CHECK BY DATE	APPROVE BY DATE
A0	ECN-130105	Mass Production	Lucas 01/10/13	Roy 01/10/13	Roy 01/10/13

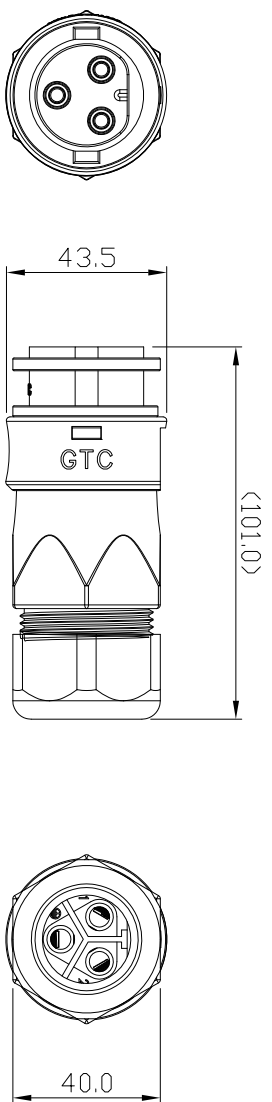
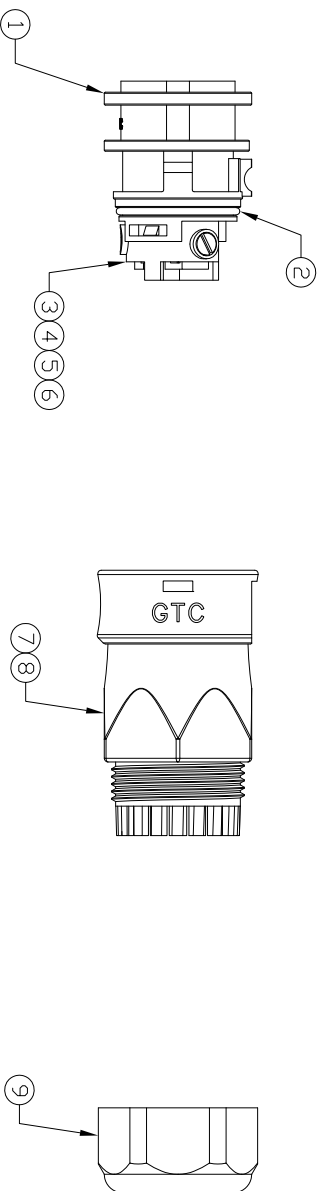
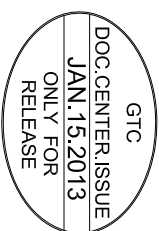

9	Gland Nut	Thermoplastic Color: Black	1
8	Gland	NBR Color: Black	1
7	Cover	Thermoplastic Color: Black	1
6	Machine Screw	S15C Finish: Ni Plated Thermoplastic Color: Black	3
5	Fixed lid Female 3P	Thermoplastic Color: Black	1
4	Terminal	Copper Alloy Finish: Sn Plated	3
3	Contacts	Copper Alloy Finish: Ni Plated	3
2	O-ring	Silicone Color: Red	1
1	Housing	Thermoplastic Color: Black	1
Item Part Name		Material / Finish	Qty

TITLE
Power M35 41A 3P Field Installable Cable End Female Screw-in Push Lock

DRAWING NUMBER	REV.
GT1E1410-42032	A0

DD NOT SCALE DRAWINGS	SIZE	SCALE	DRAW / DATE	CHECK / DATE	APPROVE / DATE	TOLERANCES	UNIT	SHEET
	B	1:1	Lucas 06/14/12	Roy 06/14/12	Roy 06/14/12	XX ± 0.5 XXX ± 0.2 XXXX ANGLES ± 1°	mm	1/1

GT Contact CD,LTD
NOTICE OF PROPRIETARY PROPERTY:
THE INFORMATION CONTAINED HEREIN IS THE PROPRIETARY PROPERTY OF GT Contact CO.,LTD THE POSSESSOR AGREES TO THE FOLLOWING:
1) TO MAINTAIN THIS DOCUMENT IN CONFIDENCE
2) NOT TO REPRODUCE OR PUBLISH IT IN WHOLE OR PART
3) ALL RIGHTS RESERVED