

Notes: (Unless Otherwise Specified)

1. Waterproof Rate: IP67.
2. Recommend Panel Thickness: 0.8 to 6.0 mm.
3. Recommend Torque: 14~15 Kgf-cm.
4. Mating Cap P/N: GT1C5331X2.
5. RoHS Compliant.

REV	ECN#	DESCRIPTION OF REVISION	DRAW BY DATE	CHECK BY DATE	APPROVE BY DATE
01			Whitney 08/15/18	Lucas 08/15/18	Ray 08/15/18

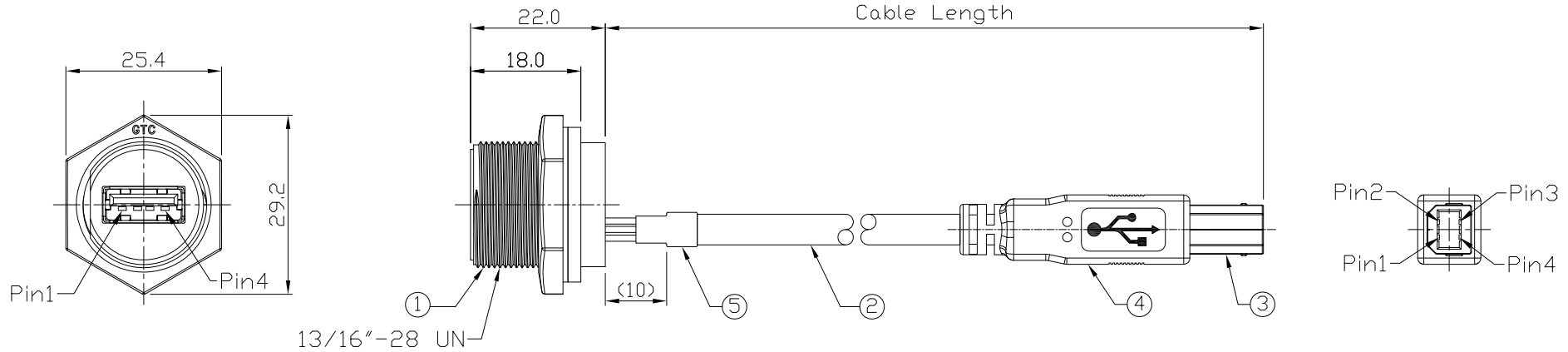

GTC
DOC.CENTER.ISSUE
AUG.15.2018
ONLY FOR
RELEASE

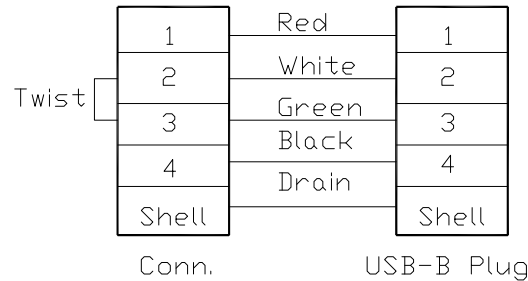

Wiring Diagram

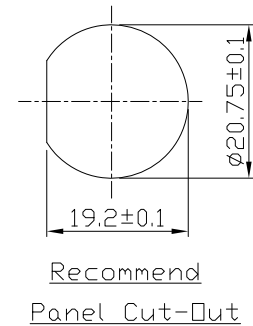

Part No.	Cable Length	Tol.
GT116300-09-05	5000 mm	+150
GT116300-09-04	4000 mm	+150
GT116300-09-03	3000 mm	+100
GT116300-09-02	2000 mm	+100
GT116300-09-01	1000 mm	+50
GT116300-09-29	900 mm	+50
GT116300-09-28	800 mm	+50
GT116300-09-27	700 mm	+50
GT116300-09-26	600 mm	+50
GT116300-09-25	500 mm	+50
GT116300-09-24	400 mm	+50
GT116300-09-23	300 mm	+25
GT116300-09-22	200 mm	+25
GT116300-09-21	100 mm	+25

Item	Part Name	Material / Finish	Q'ty
5	Shrink Tube	L=20mm Color: Black	1
4	Over Mold	PVC Color: Black	1
3	USB-B Plug	Housing: Thermoplastic, Color: Black Contacts: Copper Alloy, Finish: Au Plated Shell: Cold Roll Steel, Finish: Ni Plated	1
2	Cable	UL2725 1P*28AWG+2C*24AWG+Al/My+D+B OD=5.0mm, Color: Black	1
1	USB-A Plastic C3 Panel Jack Screw	GT Contact P/N: GT116300-0X-XX	1

TITLE						DRAWING NUMBER			REV.	
USB-A Plastic C3 Panel Jack Screw With Cable + USB B Plug						GT116300-09-XX			01	
THIRD ANGLE PROJECTION	SIZE	SCALE	DRAW / DATE	CHECK / DATE	APPROVE / DATE	TOLERANCES		UNIT	SHEET	
	B	1:1	Whitney 08/15/18	Lucas 08/15/18	Ray 08/15/18	X.X ± 0.5 X.XX ± 0.2	X.XXX ± 0.05 ANGLES ± 1°	mm	1/1	

GT Contact CO.,LTD

NOTICE OF PROPRIETARY PROPERTY:
THE INFORMATION CONTAINED HEREIN IS THE PROPRIETARY PROPERTY OF GT Contact CO.,LTD THE POSSESSOR AGREES TO THE FOLLOWING:
(a) TO MAINTAIN THIS DOCUMENT IN CONFIDENCE
(b) NOT TO REPRODUCE OR COPY IT
(c) NOT TO REVEAL OR PUBLISH IT IN WHOLE OR PART
(d) ALL RIGHTS RESERVED