

1

2

3

4

Notes: (Unless Otherwise Specified)

- 1. Waterproof Rate: IP68.
- 2. RoHS Compliant.

REV	ECN#	DESCRIPTION OF REVISION	DRAW BY DATE	CHECK BY DATE	APPROVE BY DATE
04	ECN-160118	1. Modify Item No. 1,2,4,5 Material SUS ---> Copper Alloy 2. Drawing Number GT2C632062 ---> GT2C613062	Hank 02/03/16	Lucas 02/03/16	Ray 02/06/16

D

D

C

C

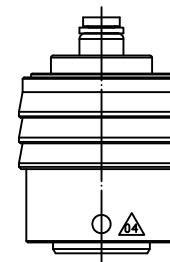
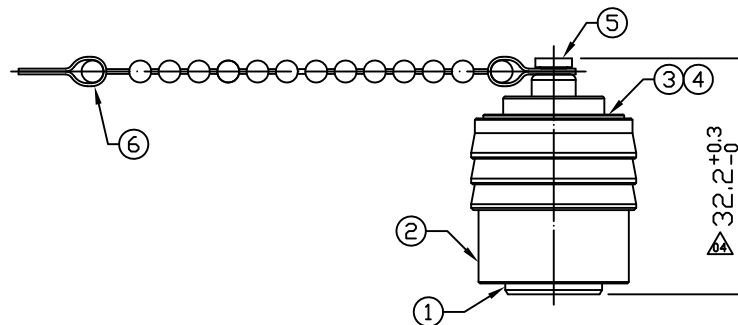
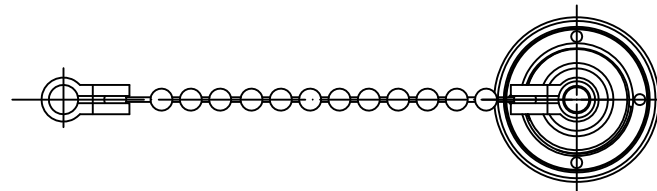

B

B

6	Metal Chain	Stainless Finish:-	1	
5	Metal Rivet	Copper Alloy Finish: Ni Plated	1	△△
4	Metal Holder	Copper Alloy Finish: Ni Plated	1	△△
3	Spring	Stainless Finish:-	1	
2	Metal Push Nut	Copper Alloy Finish: Ni Plated	1	△△
1	Metal Body	Copper Alloy Finish: Ni Plated	1	△△
Item	Part Name	Material / Finish	Q'ty	

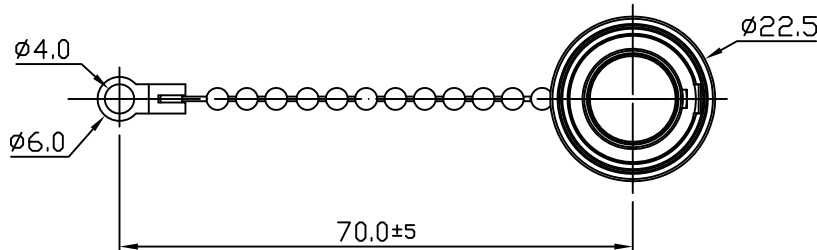

A

A

TITLE Push Lock S3 Cap For Panel With Metal Chain (M3 Screw)						DRAWING NUMBER GT2C613062			REV. 04		
THIRD ANGLE PROJECTION	SIZE	SCALE	DRAW / DATE	CHECK / DATE	APPROVE / DATE	TOLERANCES	UNIT	SHEET			
	B	1:1	Hank 11/18/13	Ray 11/18/13	Ray 11/18/13	X.X ± 0.5 X.XX ± 0.2	mm	X.XXX ± 0.05 ANGLES ± 1°	1/1		

GT Contact CO.,LTD

NOTICE OF PROPRIETARY PROPERTY:
THE INFORMATION CONTAINED HEREIN IS THE PROPRIETARY PROPERTY OF GT Contact CO.,LTD THE POSSESSOR AGREES TO THE FOLLOWING:
 (1) TO MAINTAIN THIS DOCUMENT IN CONFIDENCE
 (2) NOT TO REPRODUCE OR COPY IT
 (3) NOT TO REVEAL OR PUBLISH IT IN WHOLE OR PART
 (4) ALL RIGHTS RESERVED

1

2

3

4