

1

2

3

4

Notes: (Unless Otherwise Specified)

- 1. Waterproof Rate : IP68.
- 2. Cable Diameter: 4.0 to 6.5 mm.
- 3. Recommend Cover Torque: 6~7 Kgf-cm.
- 4. Recommend Gland Nut Torque: 9~10 Kgf-cm.
- 5. RoHS Compliant.

REV	ECN#	DESCRIPTION OF REVISION	DRAW BY DATE	CHECK BY DATE	APPROVE BY DATE
AO		Mass Production	Joyce 07/16/12	Lucas 07/16/12	Ray 07/16/12

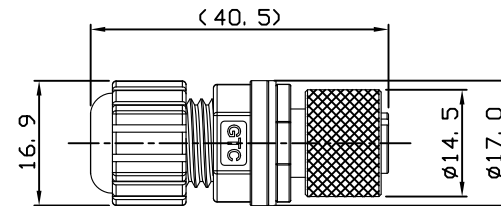
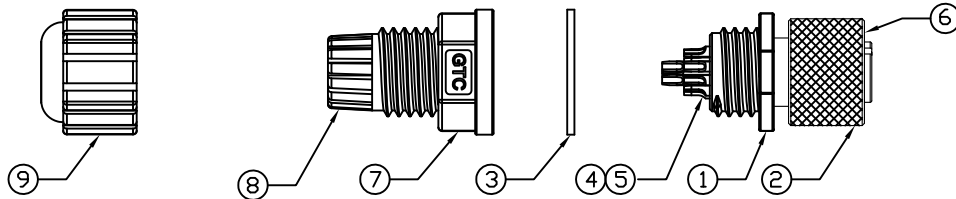

9	Gland Nut	Thermoplastic Color: Black	1
8	Gland	NBR Color: Black	1
7	Cover	Thermoplastic Color: Black	1
6	O-Ring	Silicone Color: Red	1
5	Glue	Epoxy Color: Black	
4	Contacts	Copper Alloy Finish: Au Plated	12
3	Gasket	EPDM Color: Black	1
2	Screw Nut	Copper Alloy Finish: Ni Plated	1
1	Housing	Thermoplastic Color: Black	1
Item	Part Name	Material / Finish	QTY

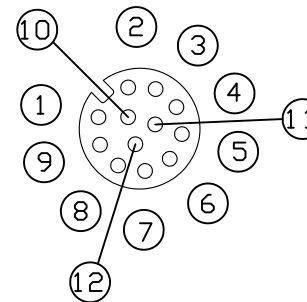
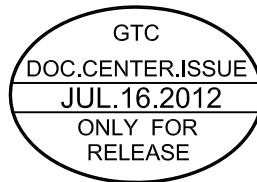

Pin Assignment
Front View
Scale 2:1

GT Contact CO., LTD

NOTICE OF PROPRIETARY PROPERTY:

THE INFORMATION CONTAINED HEREIN IS THE PROPRIETARY PROPERTY OF GT Contact CO., LTD THE POSSESSOR AGREES TO THE FOLLOWING:
 (1) TO MAINTAIN THIS DOCUMENT IN CONFIDENCE
 (11) NOT TO REPRODUCE OR COPY IT
 (111) NOT TO REVEAL OR PUBLISH IT IN WHOLE OR PART
 (1111) ALL RIGHTS RESERVED

TITLE						DRAWING NUMBER			REV.	
M12 A-Coding 1.5A 12P Field Installable Cable End Female Solder						GT234144-04120			AO	
	B	1:1	Karen 11/11/09	Ray 11/11/09	Ray 11/11/09	X.X ± 0.5 X.XX ± 0.2	X.XXX ± 0.05 ANGLES ± 1°	mm	1/1	
THIRD ANGLE PROJECTION	SIZE	SCALE	DRAW / DATE	CHECK / DATE	APPROVE / DATE	TOLERANCES		UNIT	SHEET	

1

2

3

4