

Notes: (Unless Otherwise Specified)

- 1. Waterproof Rate: IP67.
- 2. Recommend Panel Thickness: 0.8 to 6.0 mm.
- 3. Recommend Torque: 19~20 Kgf-cm.
- 4. Mating Cap P/N: GT1C1110X2.
- 5. RoHS Compliant.

REV	ECN#	DESCRIPTION OF REVISION	DRAW BY DATE	CHECK BY DATE	APPROVE BY DATE
A0	ECN-200302	1. Modify Material Item No.9 2. Addition Material Item No.11	Hank 03/04/20	Lucas 03/04/20	Ray 03/04/20

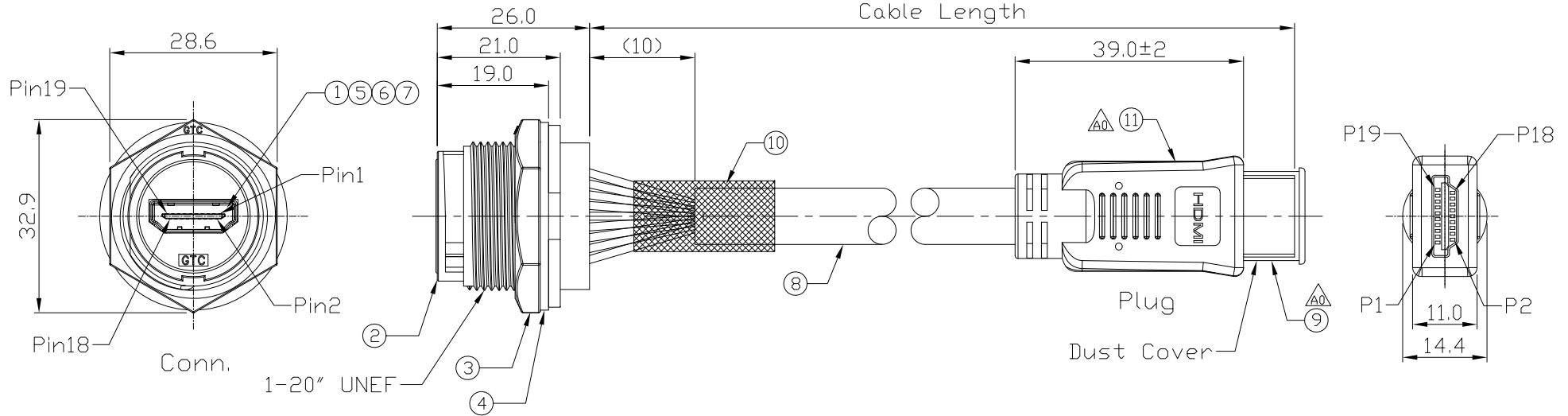

Item	Part Name	Material / Finish	Qty
11	Over Mold	PVC Color: Black	1
10	Shrink Tube	L=20mm Color: Black	1
9	HDMI Male	Housing: Thermoplastic, Color: Black Contacts: Copper Alloy, Finish: Au Plated Shell: Copper Alloy, Finish: Au Plated	1
8	Cable	UL20276((1PR/24#)+EAM)*4+(1P/24#)+(4C/24#))+AB90%	1
7	Glue	Epoxy Color: Black	
6	Hold	Silicone Color: Black	1
5	PCB	FR-4 Color: Black	1
4	Gasket	Silicone Color: Black	1
3	Hex Nut	Thermoplastic Color: Black	1
2	Housing	Thermoplastic Color: Black	1
1	HDMI Female	Housing: Thermoplastic, Color: Black Contacts: Copper Alloy, Finish: Au Plated Shell: Copper Alloy, Finish: Ni Plated	1

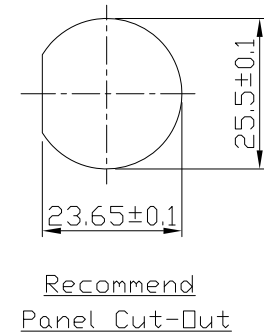
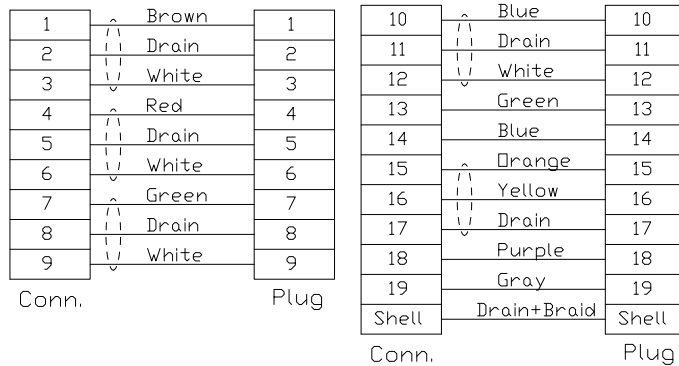

GTC  
DOC.CENTER.ISSUE  
MAR.04.2020  
ONLY FOR  
RELEASE

Part No.	Cable Length	Tol.
GT1H1200-02-10	10000 mm	+500
GT1H1200-02-09	9000 mm	+450
GT1H1200-02-08	8000 mm	+400
GT1H1200-02-07	7000 mm	+150
GT1H1200-02-06	6000 mm	+150

TITLE						DRAWING NUMBER			REV.	
HDMI C4 Plastic Panel Female Lock With HDMI Plug						GT1H1200-02-XX(06-10)			A0	
THIRD ANGLE PROJECTION	SIZE	SCALE	DRAW / DATE	CHECK / DATE	APPROVE / DATE	X.X ± 0.5	X.XXX ± 0.05	mm	1/1	
						TOLERANCES		UNIT	SHEET	

GT Contact CO.,LTD

NOTICE OF PROPRIETARY PROPERTY:

THE INFORMATION CONTAINED HEREIN IS THE PROPRIETARY PROPERTY OF GT Contact CO.,LTD THE POSSESSOR AGREES TO THE FOLLOWING:

(a) TO MAINTAIN THIS DOCUMENT IN CONFIDENCE

(b) NOT TO REPRODUCE OR COPY IT

(c) NOT TO REVEAL OR PUBLISH IT IN WHOLE OR PART

(d) ALL RIGHTS RESERVED