

- Notes: (Unless Otherwise Specified)
1. Waterproof Rate: IP67.
 2. Suitable Cable OD=21mm To 24mm
 3. Recommend Gland Nut Torque: 15~20 Kgf-cm.
 4. RoHS Compliant.

REV	ECN#	DESCRIPTION OF REVISION	DRAW BY DATE	CHECK BY DATE	APPROVE BY DATE
A0	ECN-130105	Mass Production	Lucas 01/10/13	Roy 01/10/13	Roy 01/10/13

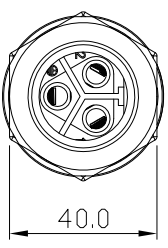
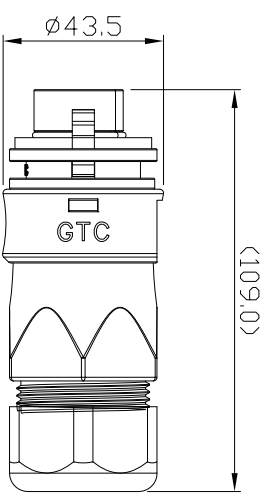
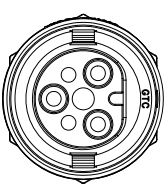
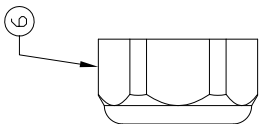
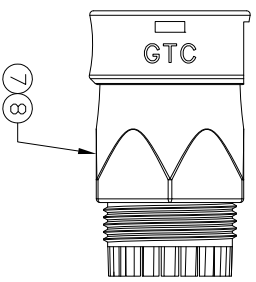
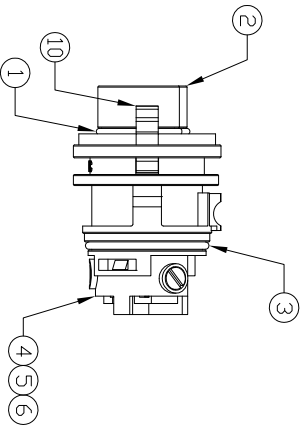
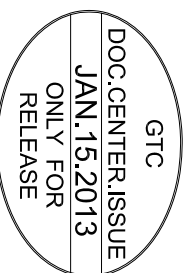

Item	Part Name	Material / Finish	Qty
10	Clamp	Thermoplastic Color: Red	1
9	Gland Nut	Thermoplastic Color: Black	1
8	Gland	NBR Color: Black	1
7	Cover	Thermoplastic Color: Black	1
6	Machine Screw	S15C Finish: Ni Plated	3
5	Fixed Lip Male 3P	Thermoplastic Color: Black	1
4	Contacts	Copper Alloy Finish: Ni Plated	3
3	D-ring	Silicone Color: Red	1
2	Housing	Thermoplastic Color: Black	1
1	D-ring	Silicone Color: Red	1

TITLE Power M35 41A 3P Field Installable Cable End Male Screw-in Push Lock

DRAWING NUMBER G11E1411-42032 REV. A0

THIRD ANGLE PROJECTION	SIZE	SCALE	DRAW / DATE	CHECK / DATE	APPROVE / DATE	TOLERANCES	UNIT	SHEET
1	B	1:1	Lucas 06/14/12	Roy 06/14/12	Roy 06/14/12	XX ± 0.5 XXX ± 0.2	mm	1/1

GT Contact CD, LTD
 NOTICE OF PROPRIETARY PROPERTY:
 THE INFORMATION CONTAINED HEREIN IS THE PROPRIETARY PROPERTY OF GT Contact CO.,LTD THE POSSESSOR AGREES TO THE FOLLOWING:
 ① TO MAINTAIN THIS DOCUMENT IN CONFIDENCE
 ② NOT TO REPRODUCE OR PUBLISH IT IN WHOLE OR PART
 ③ ALL RIGHTS RESERVED