

1

2

3

4

Notes: (Unless Otherwise Specified)

- 1. Waterproof Rate: IP67.
- 2. RoHS Compliant.

REV	ECN#	DESCRIPTION OF REVISION	DRAW BY DATE	CHECK BY DATE	APPROVE BY DATE
A0		Mass Production	Joyce 07/13/15	Lucas 07/13/15	Ray 07/13/15

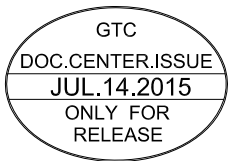
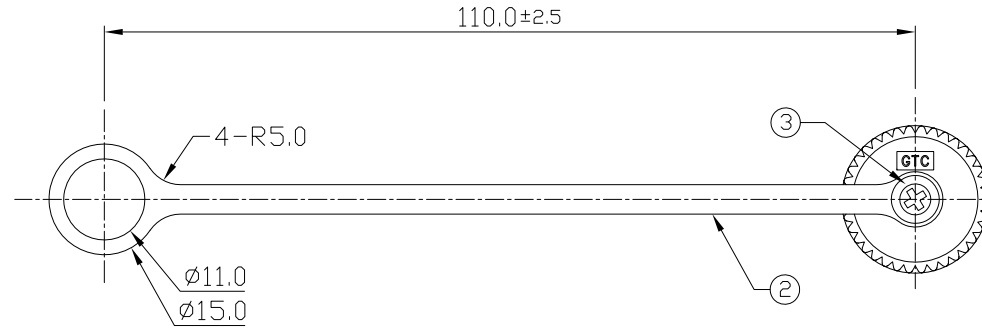

Item	Part Name	Material / Finish	Q'ty
3	Tapping Screw	SUS303 Finish: -	1
2	Plastic Chain	Thermoplastic Color: Black	1
1	Housing	Thermoplastic Color: Black	1

TITLE Cap Plastic For M12 Female End With Plastic Chain						DRAWING NUMBER GT1C343032			REV. A0	
--	--	--	--	--	--	------------------------------	--	--	------------	--

THIRD ANGLE PROJECTION	SIZE	SCALE	DRAW / DATE	CHECK / DATE	APPROVE / DATE	TOLERANCES	UNIT	SHEET
 DO NOT SCALE DRAWINGS	B	1:1	Joyce 07/13/15	Lucas 07/13/15	Ray 07/13/15	X.X ± 0.5 X.XX ± 0.2 X.XXX ± 0.05 ANGLES ± 1°	mm	1/1

GT Contact CO.,LTD

NOTICE OF PROPRIETARY PROPERTY:

THE INFORMATION CONTAINED HEREIN IS THE PROPRIETARY PROPERTY OF GT Contact CO.,LTD THE POSSESSOR AGREES TO THE FOLLOWING:

- (i) TO MAINTAIN THIS DOCUMENT IN CONFIDENCE
- (ii) NOT TO REPRODUCE OR COPY IT
- (iii) NOT TO REVEAL OR PUBLISH IT IN WHOLE OR PART
- (iv) ALL RIGHTS RESERVED

1

2

3

4