

Notes: (Unless Otherwise Specified)

1. Waterproof Rate: IP68.
2. Recommend Panel Thickness: 2.0 to 3.5 mm.
3. Recommend Torque: 5~6 Kgf-cm.
4. Mating Cap P/N: GT1C4140X2.
5. RoHS & REACH Compliant.

REV	ECN#	DESCRIPTION OF REVISION	DRAW BY DATE	CHECK BY DATE	APPROVE BY DATE
A4	ECN-230316	Update D-SUB 9P Connector	Jenny 03/25/23	Lucas 03/25/23	Ray 03/25/23

GTC
DOC.CENTER.ISSUE
MAR.29.2023
ONLY FOR
RELEASE

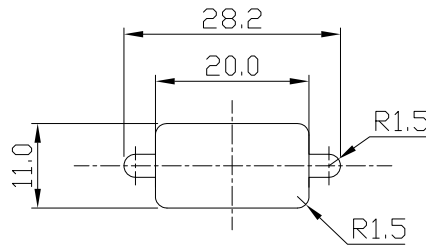

Recommend
Panel Cut-Out

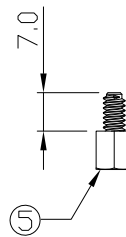
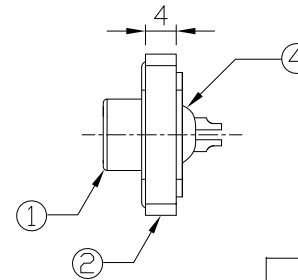
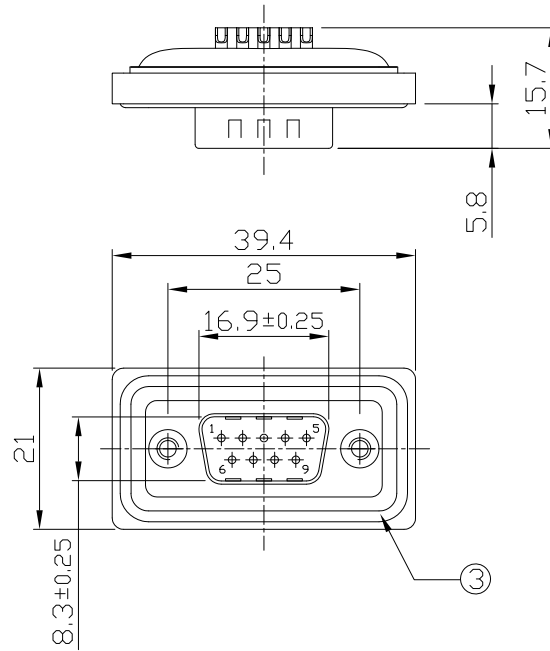

Screws on The Separate Bag

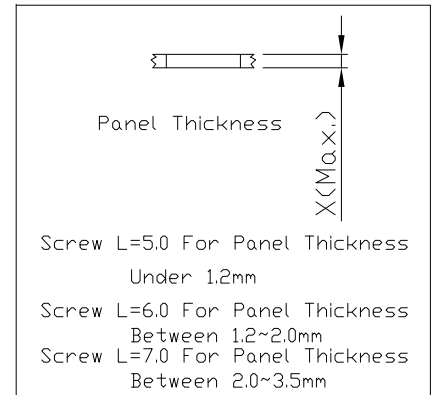

Item	Part Name	Material / Finish	Q'ty
5	Machine Screw	#4-40, Copper Alloy Finish: Ni Plated	2
4	Glue	Epoxy Color: Black	
3	O-Ring	Silicone Color: Red	1
2	Housing	Thermoplastic Color: Black	1
1	D-SUB 9P Male	Shell: Steel, Finish: Sn Plated	1
		Contacts: Copper Alloy, Finish: Au Plated	
		Housing: Thermoplastic, Color: Black	

TITTLE D-SUB 9P Panel Male Solder						DRAWING NUMBER GT141410-02090			REV. A4	
	B	1:1	Vicky 06/07/11	Lucas 06/07/11	Ray 06/07/11	X.X ± 0.5 X.XX ± 0.2	X.XXX ± 0.05 ANGLES ± 1°	mm	1/1	
THIRD ANGLE PROJECTION	SIZE	SCALE	DRAW / DATE	CHECK / DATE	APPROVE / DATE	TOLERANCES		UNIT	SHEET	

GT Contact CO.,LTD

NOTICE OF PROPRIETARY PROPERTY:

THE INFORMATION CONTAINED HEREIN IS THE PROPRIETARY PROPERTY OF GT Contact CO.,LTD THE POSSESSOR AGREES TO THE FOLLOWING:

(i) TO MAINTAIN THIS DOCUMENT IN CONFIDENCE
(ii) NOT TO REPRODUCE OR COPY IT
(iii) NOT TO REVEAL OR PUBLISH IT IN WHOLE OR PART
(iv) ALL RIGHTS RESERVED